

ALTERATIONS			
NO.	DATE	DESCRIPTION	APPR.

RESTRICTED - ACCOUNTABLE

SERIAL NO. _____

ESCORT VESSEL (AIRCRAFT)

BOOKLET
OF
GENERAL PLANS

- NUMBER & ORDER OF PLANS
- COVER AND TITLE PAGE
 - DIMENSIONS AND DATA
 - OUTBOARD PROFILE
 - INBOARD PROFILE
 - ISLAND STRUCTURE
 - FLIGHT DECK
 - WALKWAYS & GUN PLATFORMS
 - GALLERY DECK
 - TRACER OC (DC HOUSE PLATS
 - MAN DECK
 - SECOND DECK
 - FIRST PLATFORM
 - SECOND PLATFORM
 - PLATS IN HOLD
 - HOLD
 - INNER BOTTOM
 - MIDSHIP & TYPE SECTIONS

NOTE -
IF COPY OF THIS BOOKLET IS DELETED
OR SURFACE CHANGES ARE MADE BY
WHICH SHOULD BE SO NOTED

CHANGED FROM AUXILIARY AIRCRAFT ESCORT
VESSEL (AVG) TO AIRCRAFT CARRIER (ACT)

H.M.S. ATTACKER, AVG - 7
SAN FRANCISCO, CALIF.

PL JOSLYN M J RYMAN
MARINE ENGINEERS - NAVAL ARCHITECTS
149 NEW MONTGOMERY STREET, SAN FRANCISCO, CALIFORNIA

DESIGNATOR U.F.E.M. CHECKER R.S.A.
TRACER J.F.F.O.M. OCCUP LEADER
CHIEF DESIGNER SUPERVISOR

APPROVED: _____
DATE: _____ SUPERVISOR OF CONSTRUCTION

BU SHIPS NO 541775 SHEET 1 OF 17 SHEETS

GENERAL DIMENSIONS

LENGTH BETWEEN PERPENDICULARS 485'-0"
LENGTH OVERALL 491'-7 1/2"
BREADTH OVERALL AT MAIN DECK SPONSONS, FR. 120 87'-10 1/2"
BREADTH EXTREME AT GUN PLATFORMS, FR. 31 108'-0 1/2"
MEAN DRAFT ABOVE BOTTOM OF KEEL (DESIGNERS) 21'-0"

HEIGHTS ABOVE BOTTOM OF KEEL
(BOTTOM OF KEEL IS 1/4" BELOW MOLDED BASE LINE)

UPPER PLATFORM, TOWER MAST 110'-11 1/2"
2ND PLATFORM, TOWER MAST 102'-11 1/2"
1ST PLATFORM, TOWER MAST 85'-5 1/2"
TOP OF SHIELD ON ISLAND STRUCTURE, FOOT OF TOWER MAST 80'-5 1/2"
TOP OF FLIGHT DECK PLANKING (FORWARD) 78'-0 1/2"
TOP OF FLIGHT DECK PLANKING (AFT) 70'-5 1/2"
% OF MASTHEAD LIGHT 107'-5 1/2"
% OF RANGE LIGHT 87'-6 1/2"
% OF AIRLIGHTS 118'-0 1/2"
24 SEARCHLIGHTS 1 PLATFORM ON ISLAND STRUCTURE (FORD) 70'-0 1/2"
MASTHEAD PLATFORM 118'-0 1/2"
AERIAL ENCLOSURE PLATFORM 87'-11 1/2"

DATA
COMPLEMENT

SMALL BOATS

NO.	SIZE AND TYPE	EACH	TOTAL	MEN
2	26 MOTOR WHALEBOAT (OPEN)	22	44	
2	30 MOTOR LAUNCH	40	80	
TOTAL ACCOMMODATIONS				124 MEN

FIRE PLUGS

DECK	FR.	SIDE	NO.	DECK	FR.	SIDE	NO.
FORECASTLE	15	S	8	MAIN DECK	115	P	9
WALKWAY	24	S	2		182	P	2
	29	P	2		182	P	1
	76	S	2				
	78	S	2				
	114	S	2	SECOND DECK	11	S	1
	142	P	1		29	S	2
	143	P	1		27	S	2
	145	P	1		30	P	2
	148	S	2		181	P	2
MAIN DECK	35	P	2		182	S	1
	73	S	2		100	S	1
	108	S	2				

FIRE PLUGS (CONT)

DECK	FR.	SIDE	NO.
1ST PLAT	10	S	1
	12	S	2
	162	P	2
2ND PLAT	32	S	1
	33	S	1
	37	P	2
	39	S	1
	111	P	1
	112	S	2
	113	S	2
	114	S	2
MAG. PLAT	21	S	1
HOLD	81	S	1
	103	S	1
	111	S	1
TOTAL 74			

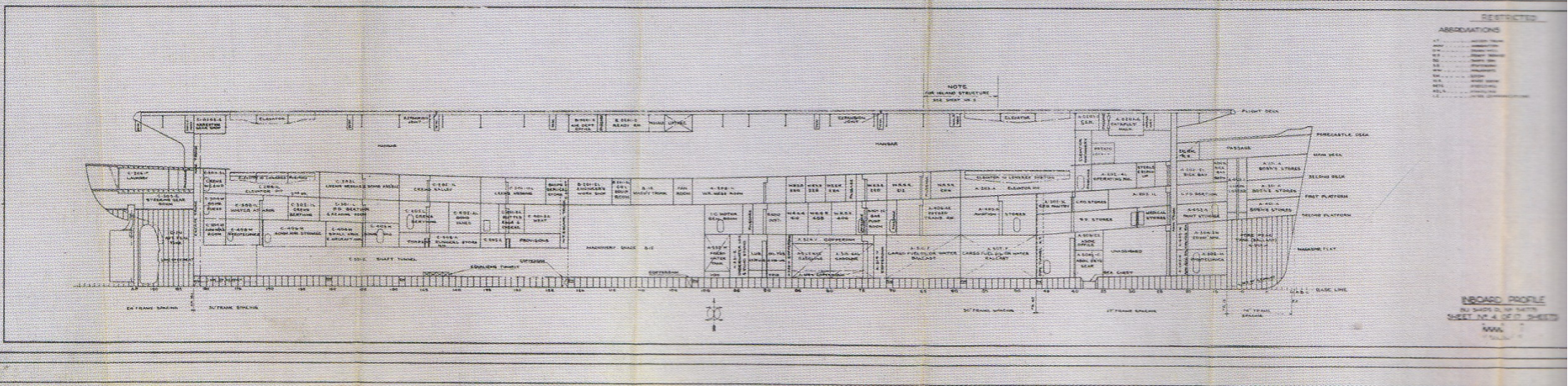

INBOARD PROFILE
BU SHIPS NO 541775
SHEET NO 4 OF 17 SHEETS
1944

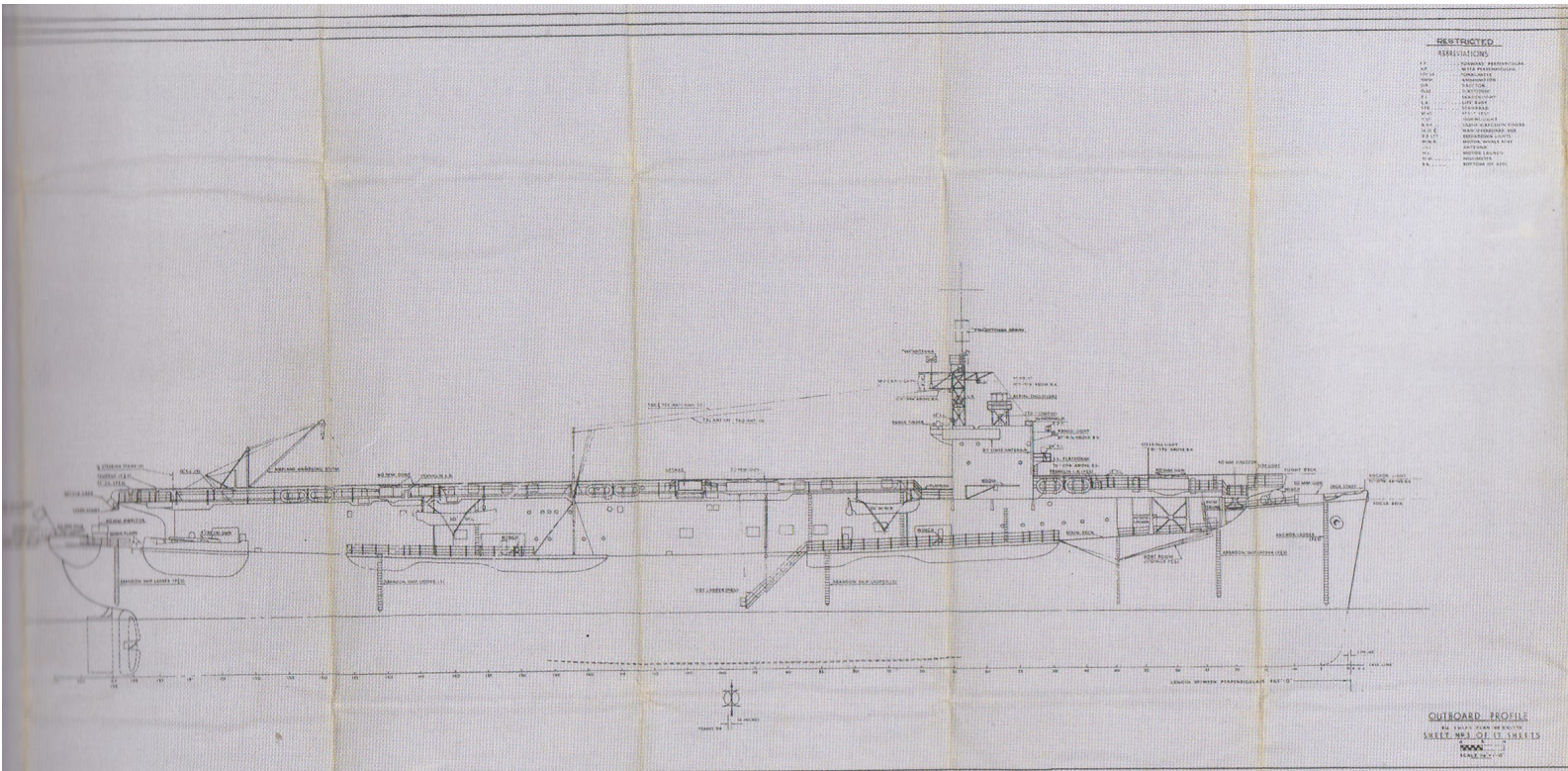

RESTRICTED
ABBREVIATIONS

AP	ANCHOR PULLEY BLOCK
CP	CORNER PLATE
DL	DECK LIFT
EL	ELECTRICAL
FL	FLOOR
GL	GUN
HL	HULL
IL	INTERNAL
LA	LIFE RAFT
LP	LIFE PULLEY
PL	PLATE
PP	PORT PULLEY
RP	RUDDER PULLEY
SP	STEERING PULLEY
TP	TOP PLATFORM
UP	UPPER
VP	VENT PIPING
WP	WATER PIPING
XP	EXHAUST PIPING
YP	YARD PIPING
ZP	ZINC
AP	ANCHOR PULLEY BLOCK
CP	CORNER PLATE
DL	DECK LIFT
EL	ELECTRICAL
FL	FLOOR
GL	GUN
HL	HULL
IL	INTERNAL
LA	LIFE RAFT
LP	LIFE PULLEY
PL	PLATE
PP	PORT PULLEY
RP	RUDDER PULLEY
SP	STEERING PULLEY
TP	TOP PLATFORM
UP	UPPER
VP	VENT PIPING
WP	WATER PIPING
XP	EXHAUST PIPING
YP	YARD PIPING
ZP	ZINC

QUICBOARD PROFILE
BY WESTERN PIPE & STEEL CO.
SHEET NO. 3 OF 11 SHEETS
SCALE: 1/4" = 1'-0"

CHANGED FROM AUXILIARY AIRCRAFT ESCORT VESSEL (AVES) TO AUXILIARY AIRCRAFT CARRIER (ACV).

H.M.S. ATTACKER AVG 7

BUILT BY
THE WESTERN PIPE & STEEL CO.
SAN FRANCISCO, CALIF.

P. L. JOSLYN
M. J. RYAN
MARINE ENGINEERS NAVAL ARCHITECTS
115 NEW MONTGOMERY STREET, SAN FRANCISCO, CALIF.

DRWG. NO. AVG0103-5, W.P.I.
SCALE 1/4" = 1'-0" DRAWN BY J.F.E.M. DATE 7-22-44
CHECKED BY H.M.M. CHIEF DRAFTSMAN APPROVED

BOOKLET
OF
GENERAL PLANS
SHEET NO. 1

FINISHED PLAN
TAKEN FROM WORK EXAMINED & FOUND CORRECT
WESTERN PIPE & STEEL CO.

APPROVED: _____ DATE: _____
BUREAU OF SHIPS PLAN NUMBER
541775

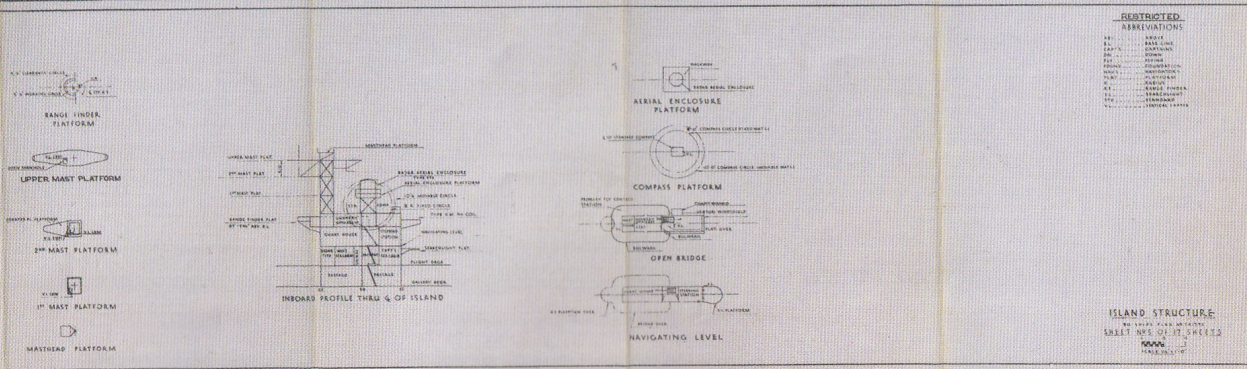

RESTRICTED
ABBREVIATIONS

AP	ANCHOR PULLEY BLOCK
CP	CORNER PLATE
DL	DECK LIFT
EL	ELECTRICAL
FL	FLOOR
GL	GUN
HL	HULL
IL	INTERNAL
LA	LIFE RAFT
LP	LIFE PULLEY
PL	PLATE
PP	PORT PULLEY
RP	RUDDER PULLEY
SP	STEERING PULLEY
TP	TOP PLATFORM
UP	UPPER
VP	VENT PIPING
WP	WATER PIPING
XP	EXHAUST PIPING
YP	YARD PIPING
ZP	ZINC

ISLAND STRUCTURE
BY WESTERN PIPE & STEEL CO.
SHEET NO. 1 OF 11 SHEETS
SCALE: 1/4" = 1'-0"

